

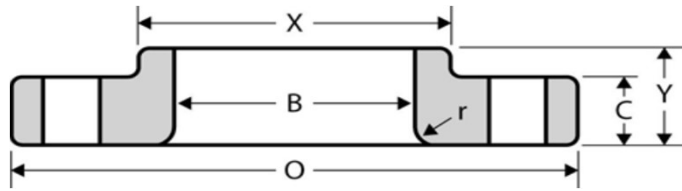

Lap Joint Flange  
**CLASS 150**  
 Inches / Pounds



Part #	Nominal Pipe Size	Outside Diam. of Flange	Thick. of Flange	Diam. of Hub at Base	Length thru Hub	Diam. of Bore	Fillet Radius (F)	No. of Holes	Diam. Of Holes	Diam. Of Bolts	Diam. Of Bolt Circle	Approx. Weight (in Lbs.)
KFLJ.25	1/2	3.50	0.44	1.19	0.62	0.90	0.12	4	0.62	0.50	2.38	1
KFLJ.75	3/4	3.88	0.50	1.50	0.62	1.11	0.12	4	0.62	0.50	2.75	2
KFLJ1	1	4.25	0.56	1.94	0.69	1.38	0.12	4	0.62	0.50	3.12	2
KFLJ1.25	1 1/4	4.62	0.62	2.31	0.81	1.72	0.19	4	0.62	0.50	3.50	3
KFLJ1.5	1 1/2	5.00	0.69	2.56	0.88	1.97	0.25	4	0.62	0.50	3.88	3
KFLJ2	2	6.00	0.75	3.06	1.00	2.46	0.31	4	0.75	0.62	4.75	5
KFLJ2.5	2 1/2	7.00	0.88	3.56	1.12	2.97	0.31	4	0.75	0.62	5.50	7
KFLJ3	3	7.50	0.94	4.25	1.19	3.60	0.38	4	0.75	0.62	6.00	8
KFLJ3.5	3 1/2	8.50	0.94	4.81	1.25	4.10	0.38	8	0.75	0.62	7.00	11
KFLJ4	4	9.00	0.94	5.31	1.31	4.60	0.44	8	0.75	0.62	7.50	13
KFLJ5	5	10.00	0.94	6.44	1.44	5.69	0.44	8	0.88	0.75	8.50	15
KFLJ6	6	11.00	1.00	7.56	1.56	6.75	0.50	8	0.88	0.75	9.50	19
KFLJ8	8	13.50	1.12	9.69	1.75	8.75	0.50	8	0.88	0.75	11.75	30
KFLJ10	10	16.00	1.19	12.00	1.94	10.92	0.50	12	1.00	0.88	14.25	43
KFLJ12	12	19.00	1.25	14.38	2.19	12.92	0.50	12	1.00	0.88	17.00	64
KFLJ14	14	21.00	1.38	15.75	3.12	14.18	0.50	12	1.12	1.00	18.75	105
KFLJ16	16	23.50	1.44	18.00	3.44	16.19	0.50	16	1.12	1.00	21.25	140
KFLJ18	18	25.00	1.56	19.88	3.81	18.20	0.50	16	1.25	1.12	22.75	160
KFLJ20	20	27.50	1.69	22.00	4.06	20.25	0.50	20	1.25	1.12	25.00	195
KFLJ24	24	32.00	1.88	26.12	4.38	24.25	0.50	20	1.38	1.25	29.50	275

\* Dimensions conform to ASTM A/SA-105; ANSI B16.5